

RACE

TRACK

NAME

CITY / COUNTRY

DATE

TEMPERATURE	AIR	TRACK	
QUALIFYING POSITION	BEST LAP TIME	FINAL POSITION	RACE LENGTH
	SEC		MIN
TRACK CONDITION	<input type="checkbox"/> TECHNICAL	<input type="checkbox"/> MIXED	<input type="checkbox"/> FAST
TRACTION	<input type="checkbox"/> LOW	<input type="checkbox"/> MEDIUM	<input type="checkbox"/> HIGH

### GEAR RATIO CHART

Spur	Spur 1st	Spur 2nd
Pinion	60 61 62	56 57 58
1st	<input type="checkbox"/> 18T <input type="checkbox"/> 19T <input type="checkbox"/> 20T	<input type="checkbox"/>
2nd	<input type="checkbox"/> 23T <input type="checkbox"/> 24T <input type="checkbox"/> 25T	<input type="checkbox"/>

**SHOCK**

Front: OIL  1 HOLE  2 HOLE CST SPRING

Rear: OIL  1 HOLE  2 HOLE CST SPRING

SHOCK PISTON:  1 HOLE  2 HOLE

HOLE SIZE: F  mm, R  mm

**TIRE**

Front Left:  °,  mm

Front Right:  °,  mm

Rear Left:  °,  mm

Rear Right:  °,  mm

Tire Shore:

Tire Ø:  mm

Tire Additive:

### BODY

Bumper:  Standard  Cut

BODY MOUNT DISTANCE:  mm

BODY:  mm, WING:  mm

### ENGINE

Engine	Pipe
Plug	Carb Dia <input type="text"/> mm
Fuel	Head Shims <input type="text"/> mm

### CLUTCH

Clutch Bell	Clutch Shoes
Spring Load <input type="text"/> mm	Bell Clearance <input type="text"/> mm

### NOTE

<input type="checkbox"/> R839008	<input type="checkbox"/> BRACE	WHEEL BASE	BUMP STEER	CASTER	<input type="checkbox"/> R839009	<input type="checkbox"/> BRACE
SHIM UNDER SHOCK <input type="text"/> mm		<input type="text"/> mm	<input type="text"/> mm	<input type="text"/> mm	SHIM UNDER SHOCK <input type="text"/> mm	
TOWER POSITION <input type="text"/> mm					REAR UPRIGHTSHIMS <input type="text"/> mm	

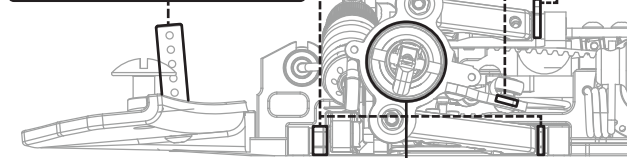

FRONT ARM:  S  M  H  R832012

### STEERING BLOCK SETUP

CENTER R806021	CENTER	BACKWARD	FORWARD	LOWER	UPPER
----------------	--------	----------	---------	-------	-------

**ECCENTER HUB**

Up  Middle  R806021

REAR ARM:  S  M  H

**FRONT**

RIDE HEIGHT:  mm

FRONT UPPER ARM:

WHEEL SHIMS:  mm

CAMBER: R  L

DOWN STOP:  mm

FRONT LOW ARM:

**REAR**

RIDE HEIGHT:  mm

2 HOLES INSIDE  1 HOLE OUTSIDE

WHEEL SHIMS:  mm

CAMBER: R  L

REAR ROLL CENTER:

I-TYPE:

REAR UPPER LINK:

DOWN STOP:  mm

REAR TOE: IN  OUT

FRONT TOE:

REAR ANTI-ROLL BAR:  mm

FRONT ANTI-ROLL BAR:  mm

UPPER DECK:  FIX  REMOVED

UPPER DECK:  FIX  REMOVED

ACKERMAN:  10mm  9mm  8.5mm

CHASSIS WEIGHT ADJUSTMENT:  REMOVED  R838008 CHASSIS COVER

TRACK WIDTH:  mm

TRACK WIDTH:  mm